

Westwood

VILLAGE

- SET 1/2" CAPPED IRON ROD
 - FOUND 1" UNCAPPED IRON PIPE
 - + RADIUS POINT
- BASIS OF BEARING - SOUTH PROPERTY LINE IS DUE EAST

FOUND R.R. SPIKE AT INTERSECTION OF ONTARIO & DIVISION

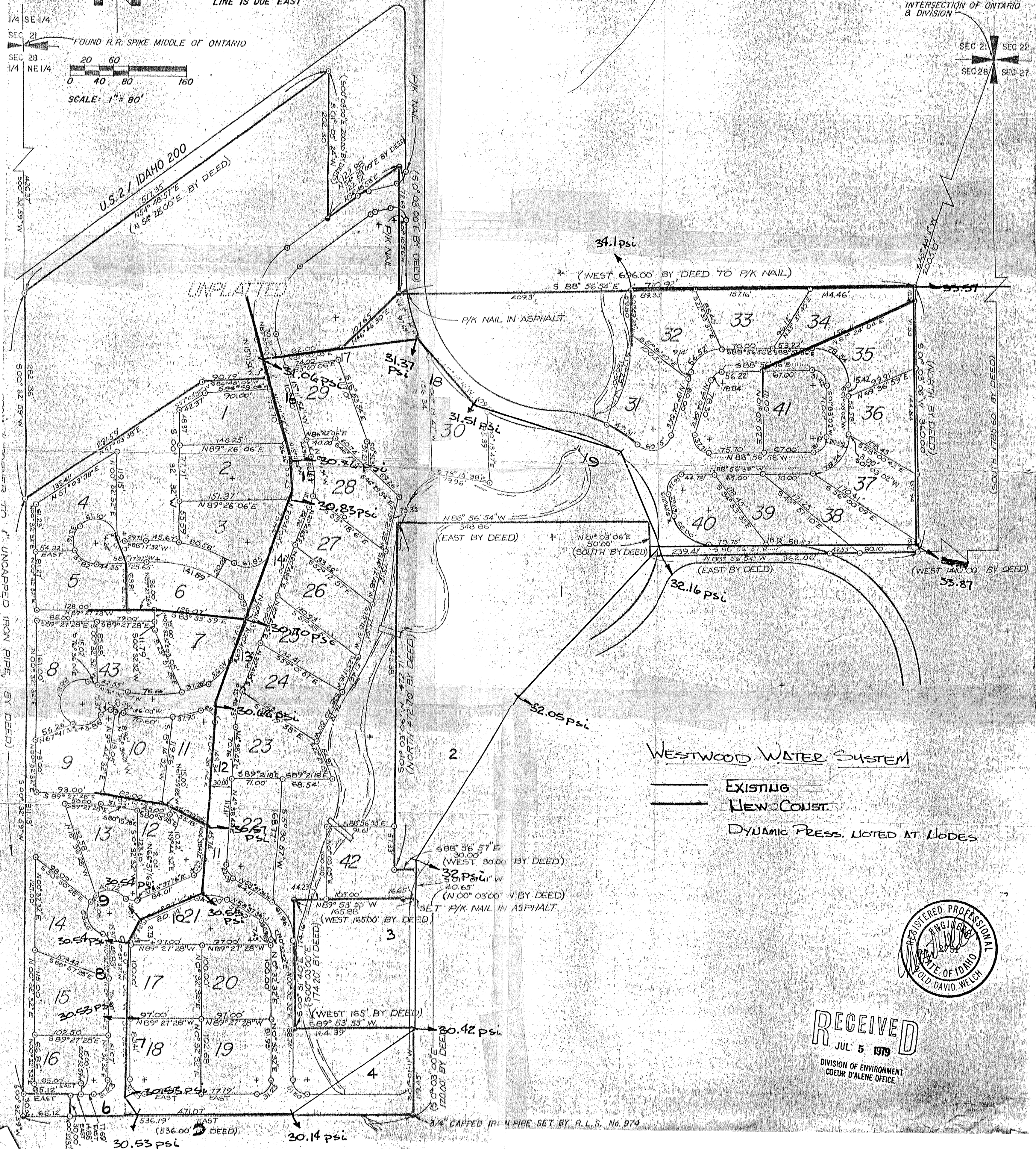
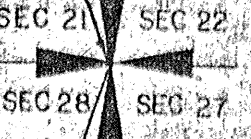
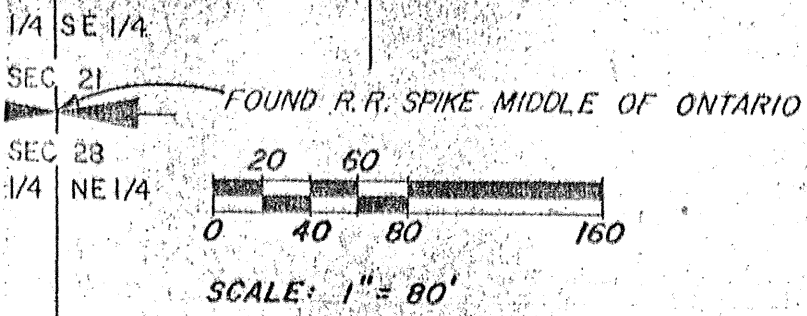

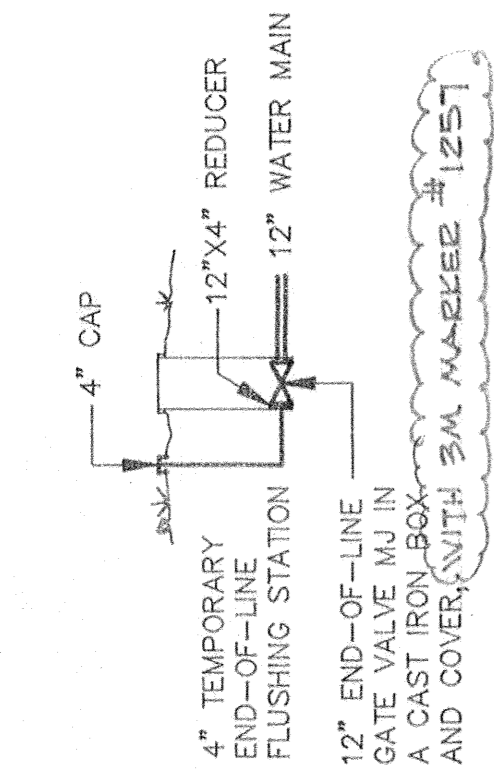

DETAIL "C"
NOT TO SCALE
(TYPICAL END OF LINE FLUSHING STATION)

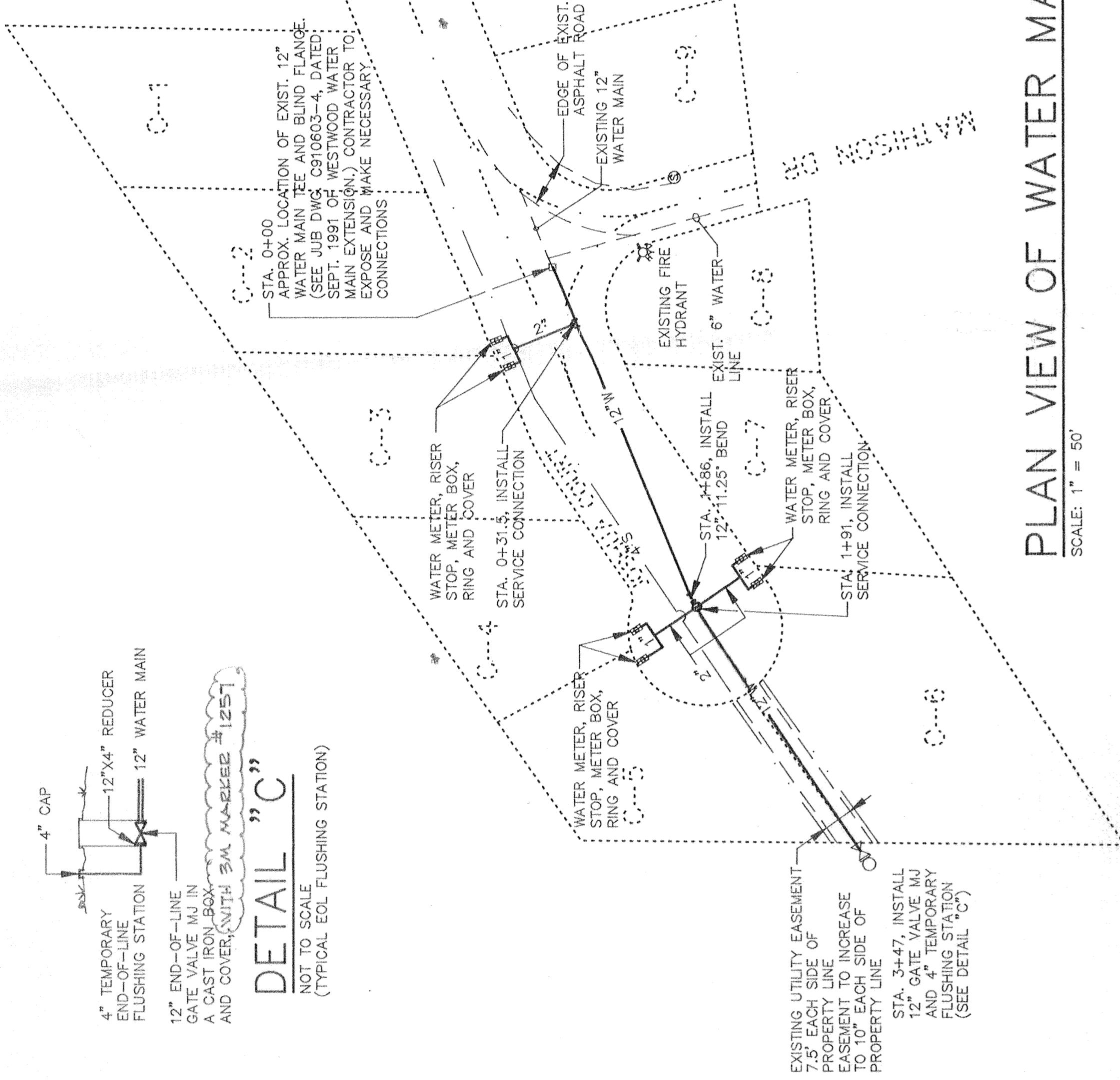

PLAN VIEW OF WATER MAIN
SCALE: 1" = 50'

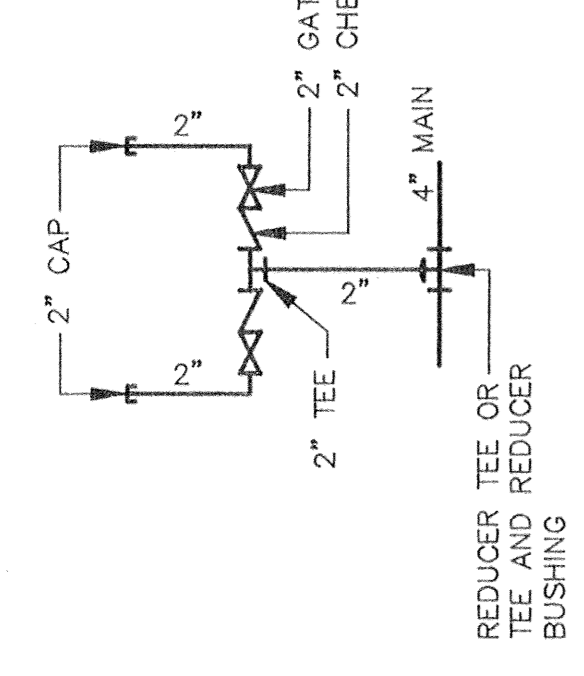
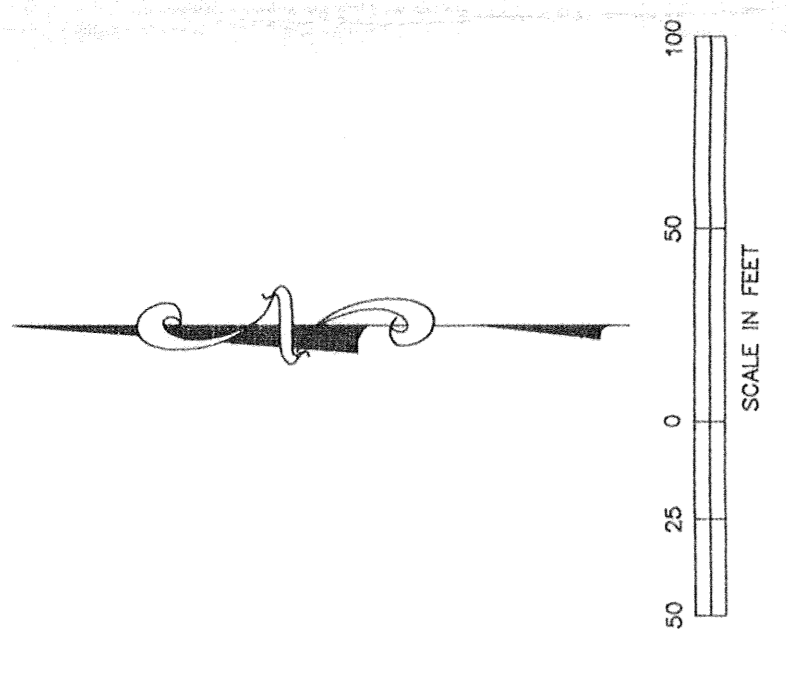

DETAIL "A"
NOT TO SCALE
(TYPICAL DUAL CONNECTION)

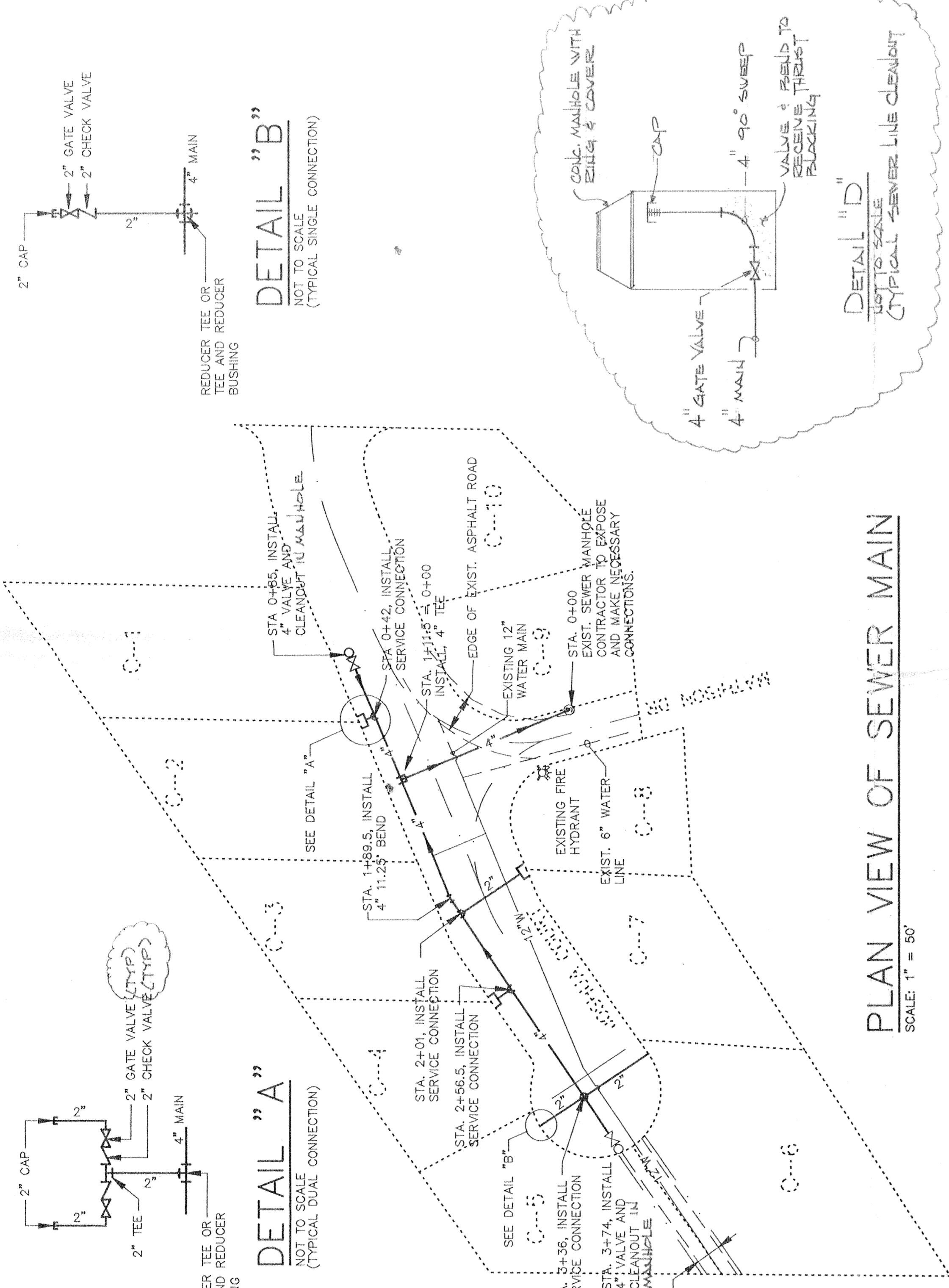

PLAN VIEW OF SEWER MAIN
SCALE: 1" = 50'

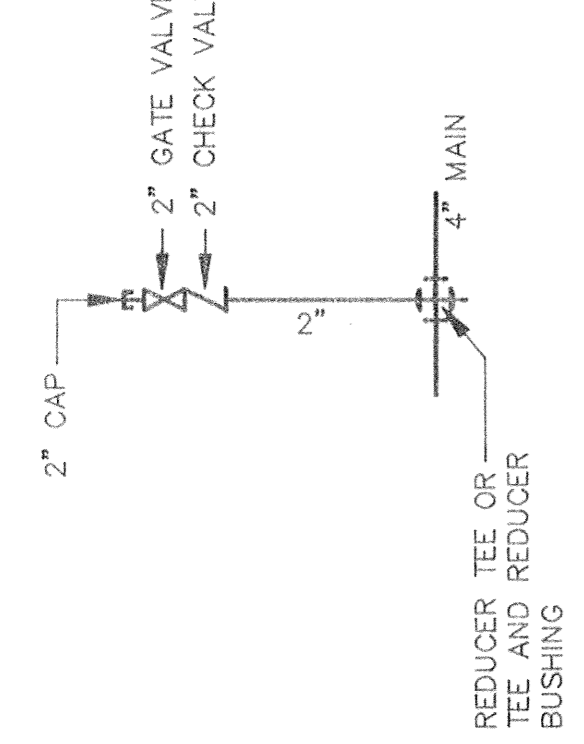

DETAIL "B"
NOT TO SCALE
(TYPICAL SINGLE CONNECTION)

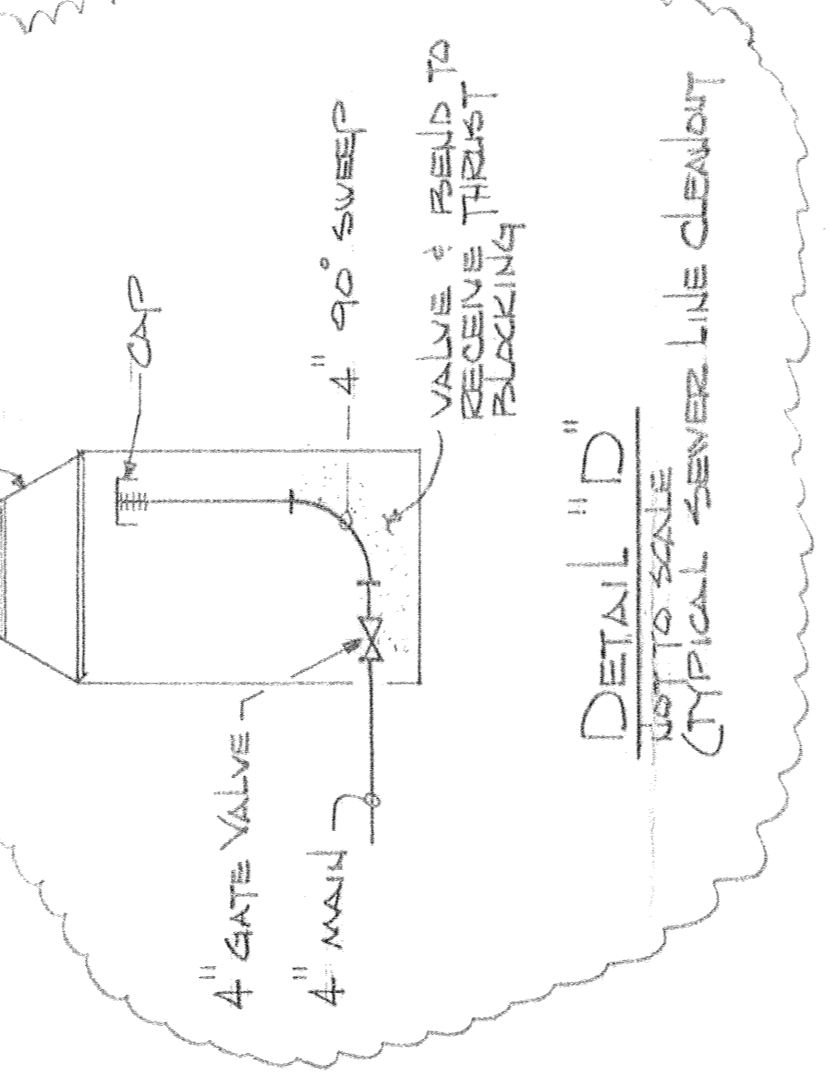

DETAIL "D"
NOT TO SCALE
(TYPICAL SEWER LINE CLEANOUT)

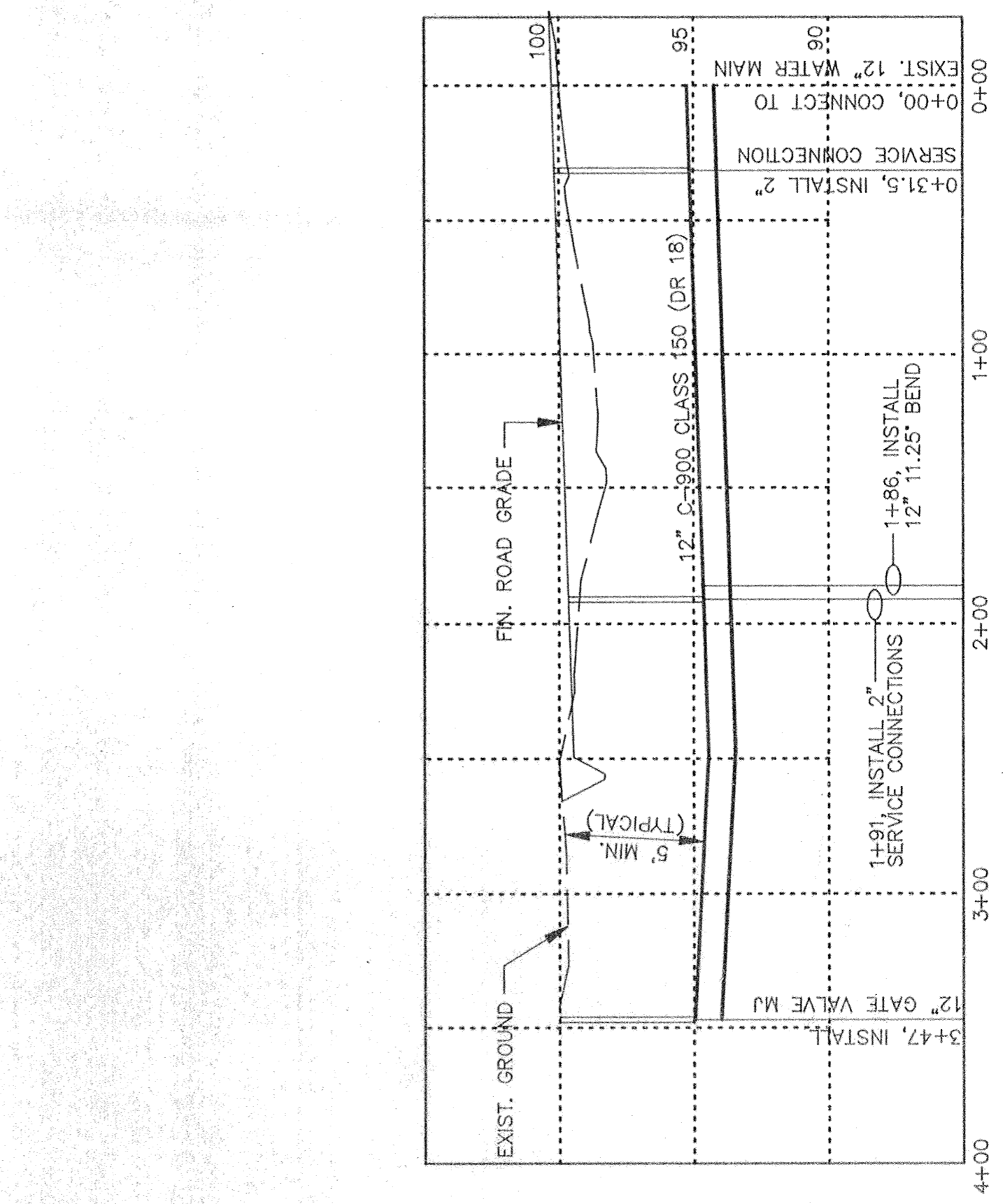

PROFILE OF WATER MAIN
SCALE: VERT = 5'
HORIZ = 50'

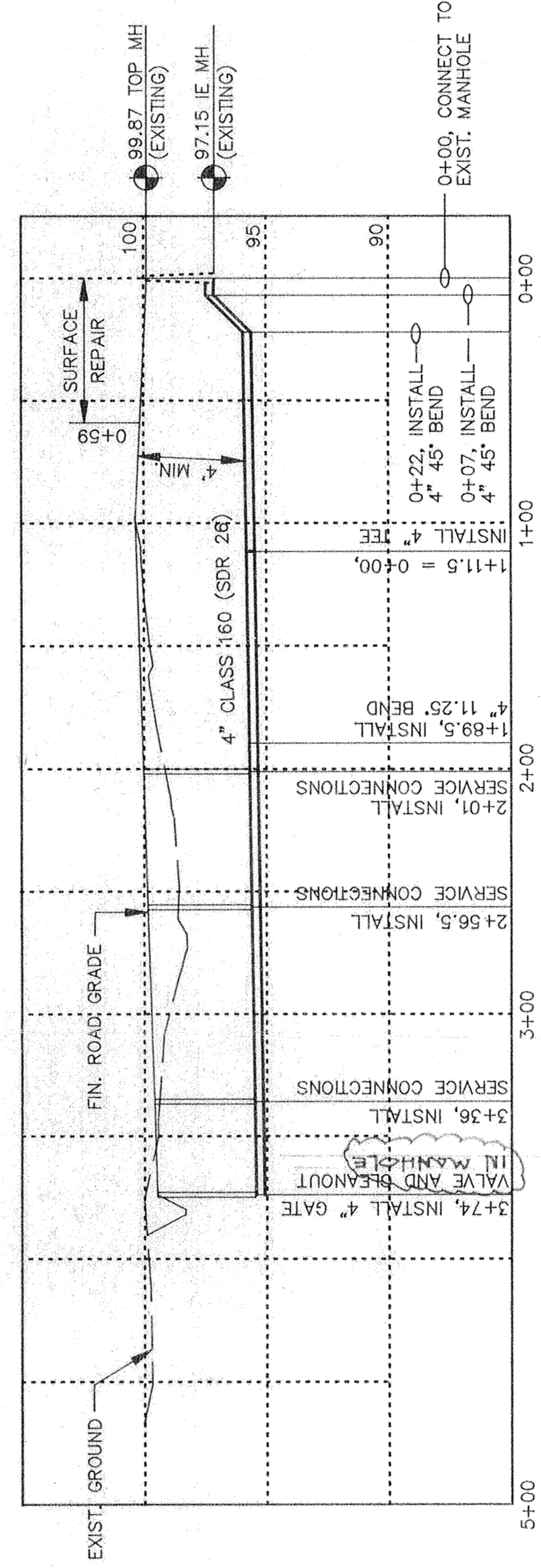

PROFILE OF SEWER MAIN
SCALE: VERT = 5'
HORIZ = 50'

- NOTES:**
1. THE LOCATION OF ALL EXISTING UNDERGROUND UTILITIES ARE SHOWN IN AN APPROXIMATE WAY ONLY. THE CONTRACTOR SHALL DETERMINE THE EXACT LOCATION OF ALL EXISTING UTILITIES BEFORE COMMENCING WORK. HE AGREES TO BE FULLY RESPONSIBLE FOR ALL DAMAGES WHICH MIGHT BE OCCASIONED BY HIS FAILURE TO EXACTLY LOCATE AND PRESERVE ALL UNDERGROUND UTILITIES, PER HB #887 CHAPTER 22 TITLE 55 IDAHO CODE.
 2. ALL CONSTRUCTION SHALL BE IN ACCORDANCE WITH IDAHO STANDARDS FOR PUBLIC WORKS CONSTRUCTION.
 3. WATER MAIN AND SERVICE TRACER WIRE TO BE 14 GAUGE SOLID CONDUCTOR WIRE LAID ATOP ALL MAINS AND SERVICES. ATTACH TO VALVES AND OTHER ACCESS POINTS.
 4. WATER CURB STOP LOCATORS - 3M MID-RANGE MARKERS #257.
 5. SEWER LATERAL LOCATORS - 3M MID-RANGE MARKERS #258.
 6. SEWER LOCATORS TO BE PLACED AT EACH SEWER SERVICE (PROPERTY LINE).
 7. SURFACE REPAIR TO BE INCIDENTAL TO INSTALLATION OF SEWER MAIN.
 8. GRINDER PUMP SEWAGE EJECTOR SYSTEM SHALL BE REQUIRED FOR EACH LOT.

REVISIONS
5-10-93 REVISIONS SHOWN AS

CALL 48 HOURS BEFORE YOU DIG
1-800-626-4950

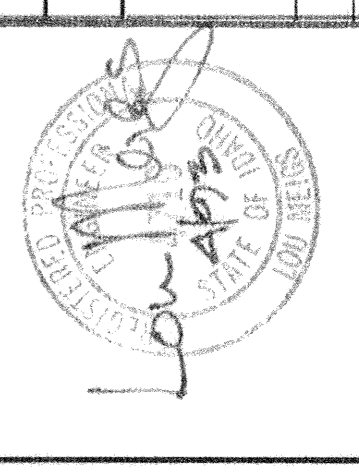

WESTWOOD VILLAGE SQUARE
WATER & SEWER LINE EXTENSION
Welch Engineering, Inc.
ENGINEERING • SURVEYING
P.O. BOX 884 - DOVER HIGHWAY - SANDPOINT, IDAHO 83884
Ph. (208) 265-8881
Drawn by: LS Date: 4-93 Sheet 1 of 3
Checked by: AS Status: AS NOTED